

BUBBLYSMOKE500

FOG & BUBBLE MACHINE

USER MANUAL

Place the machine in the appropriate position, add 250 ml of fog liquid into the container (see img 1).

Add 700 ml of bubble fluid in the dedicated vessel.

This machine of fog and bubbles can be controlled by wireless remote control, see image 2 for the function keys.

Connect the power supply and press the function keys to choose the type of use. The bubble generator can work immediately, but the smoke machine needs a preheating of 5-6 minutes.

CAUTION

- the bubble liquid must dip only the rings, it generates bubbles, it is not necessary to fill it, to prevent the bubble liquid from overflowing to cause a short-circuit.
- long use, will make the ground wet and slippery.
- if you do not use a lot of time, please keep the machine clean and avoid dust; close the power supply after each use.

picture 1

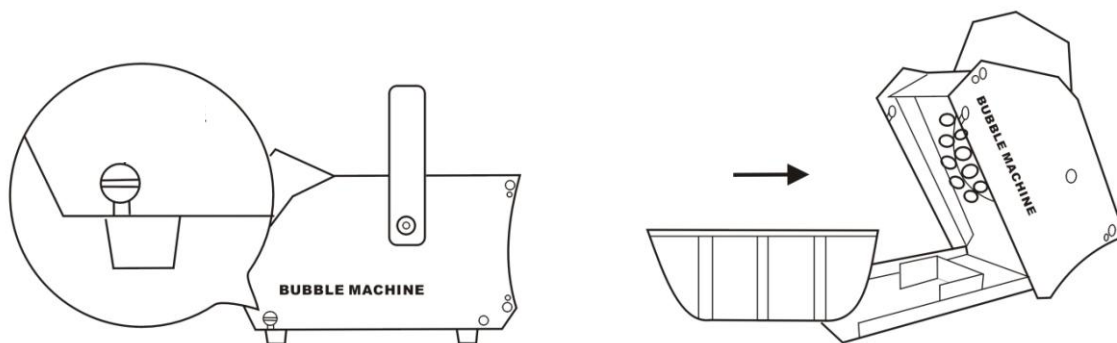

picture 2

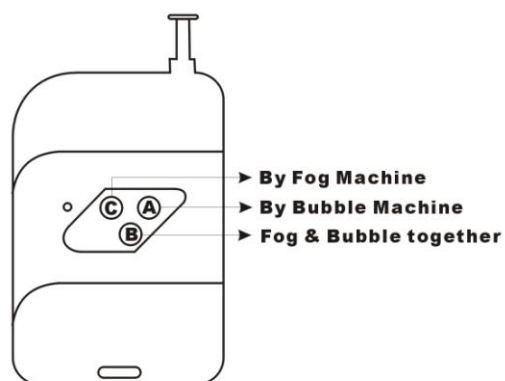

Technology Parameter	
Voltage	AC 220-240V 50/60Hz
Power	500W
Container	Fog Liquid 250 ml / Bubble Liquid 700 ml
Size(mm)	380 x280x210 mm (LxWxH)
Weight (Kg)	6



Timpani S.r.L.
Via Idiomi 1/42 - 20090 Assago MI



timpani.it



+39 051.356956



+39 342.3929868



info@timpani.it

www.timpani.it